

FEMALE END VIEW

1 = BARE (SHIELD)
2 = RED (+ VOLTAGE)
3 = BLACK (- VOLTAGE)
4 = WHITE (CAN_H)
5 = BLUE (CAN_L)

mini
fast. **DeviceNet™**

SPECIFICATIONS

CONTACT CARRIER MATERIAL	TPU
MOLDED BODY MATERIAL/COLOR	TPU/CLEAR
CONTACT MATERIAL/PLATING	BRASS/GOLD
COUPLING NUT MATERIAL/PLATING	BRASS/NICKEL
RATED VOLTAGE [V]	300 V (7.6 VDC MAX. ON PINS WITH RESISTOR)
INTERNAL TERMINATING RESISTOR	120Ω, 1/2 W
VOLTAGE MONITORING (BUS POWER)	GREEN: CORRECT POLARITY RED: REVERSED POLARITY
TEMPERATURE RATING	-40°C to +80°C (-40°F to +170°F)
PROTECTION CLASS	MEETS NEMA 1,3,4,6P AND IEC IP67

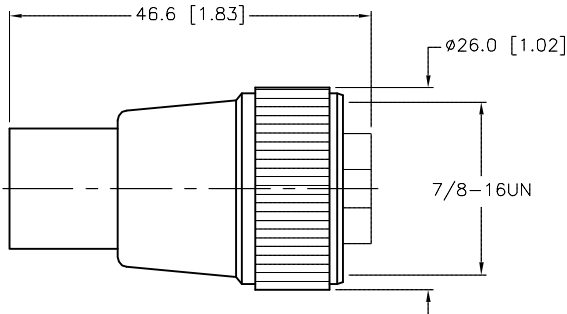

SOURCE DRAWING - FOR REFERENCE ONLY

RELATED DOCUMENTS					3RD ANGLE PROJECTION		THIS DRAWING IS CONFIDENTIAL AND THE PROPERTY OF TURCK INC. USE OF THIS DOCUMENT WITHOUT WRITTEN PERMISSION IS PROHIBITED.		<div>3000 CAMPUS DRIVE MINNEAPOLIS, MN 55441 1-800-544-7769 (763) 553-7300 (763) 553-0708 fax www.turck.us</div> <div>TURCK</div>			
1. 2. 3. 4.							DRFT DF		DATE 07/23/02		DESCRIPTION RKM 57-TR2/VM	
MATERIAL					ALL DIMENSIONS DISPLAYED ON THIS DRAWING ARE FOR REFERENCE ONLY		APVD DF		SCALE 1=1.0			
FINISH					CONTACT TURCK FOR MORE INFORMATION		UNIT OF MEASUREMENT MILLIMETER [INCH]		IDENTIFICATION NO. U0102-102		REV C	
C DRAWING PROCESSED AS PART OF ECO 33971					CBM 04/07/11		33971		DO NOT SCALE THIS DRAWING		FILE: U0102-102	
REV DESCRIPTION					BY DATE		ECO NO.				SHEET 1 OF 1	